

# GENERAL DECKING

TECHNICAL INSTALLATION GUIDE

# General Decking

## GENERAL INFORMATION & PREPARATION

1

### TOOLS



### STAINLESS STEEL SCREWS



### General information

The decking boards available from Plaswood Products are produced in 3600mm lengths, can be worked using standard wood working tools and in the same manner as wood.

The decking boards are attached to the Plaswood posts by connect system clips, not conventional screws and this allows for:



Easy and quick installation



Automatic placement of the boards at the correct parallel distance.



More aesthetically pleasing installation.



Expansion and shrinkage of the boards due to temperature fluctuations.

### RECOMMENDATION



To ensure correct drainage, place the boards lengthways at a right angle to the direction of the wall. This means the Plaswood posts are placed parallel to the wall ensuring the boards slope away from the wall.

### Preparation

Plaswood Products recommends the following to ensure ease of installation.

#### Ground preparation

- The subsoil needs to be firm, smooth and stable.
- The soil needs to slope at least 10mm per m lengthways to the direction of the boards.

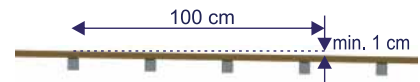

#### Tools

Always use stainless steel screws when;

- Attaching the connect system clips to the Plaswood posts; 3,5 x 30mm
- Connecting the Plaswood posts to each other; 5 x 100mm

It is advised when working with the product that all sawing and drilling be undertaken steadily and slowly.

#### Plaswood Posts

Plaswood posts from Plaswood Products are available in standard dimensions of 50mm square up to lengths of 3.1 metres, in black; other sizes available. To ensure the Plaswood posts are fully weight-bearing they must be placed onto a suitable weight-bearing subsoil.

Maximum distance between the Plaswood posts:

Angle between posts & decking boards	90°	45°
Recommended distance between the posts	350mm	250mm





# General Decking

## PLASWOOD POST INSTALLATION

2

### Plaswood Post Installation



1. The Plaswood posts are placed directly onto the subsoil but are not anchored to the ground.

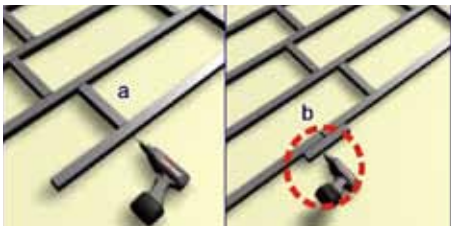

2. To ensure a stable structure, it is advised to attach crossbeams between the posts; this will also make it easier to install the boards.



3. Where more than one post is required to run the length of the application, the posts need to be attached to each other. This can be achieved by sawing off a piece of post and screwing it to both posts at the join.

4. Where 2 boards abut along the length of the application, this requires 2 posts to support the ends of the boards, i.e. one post is required to support the end of one board and another post is needed to support the start of the next board.



Plaswood Posts are an ideal solution for stabilising corner joints.

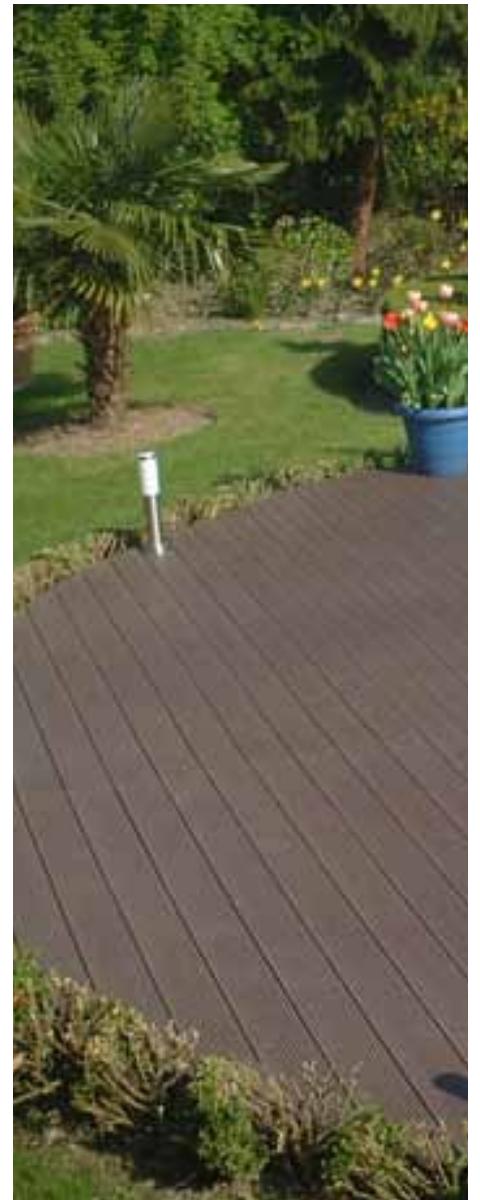

### RECOMMENDATION



Always allow a 50mm minimum expansion gap between the post and any wall. Only allow a 50mm overhang of the board at the ends of the application.



# General Decking

## DECKING BOARD INSTALLATION

3

### Decking Boards

#### General

The decking boards are manufactured at a length of 3600mm. Small tolerances in the length are normal. The cross ends of the boards display extrusion rests; these should be sawn off prior to installation.

#### Decking board Installation



1. The decking boards should be attached to the Plaswood posts by the connect system clips.



2. Each board is moulded with a groove on each length to allow the clips to glide into place.



3. The first row of boards will only require attaching to one side, 3 lips should be sawn off one side of the connect system clip.



4. Screw the first row of clips to the Plaswood posts and guide the board(s) over the clips.



5. Always ensure the clips are secured in a straight line on the Plaswood posts and always take into account the minimum 10mm expansion gap.

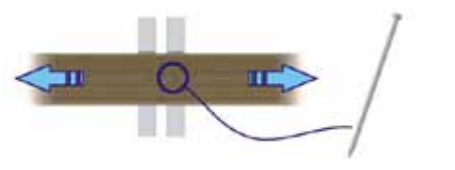

6. Once the first row of boards are laid, slide the second row of connect system clips into the opposite board groove and secure to the Plaswood post.

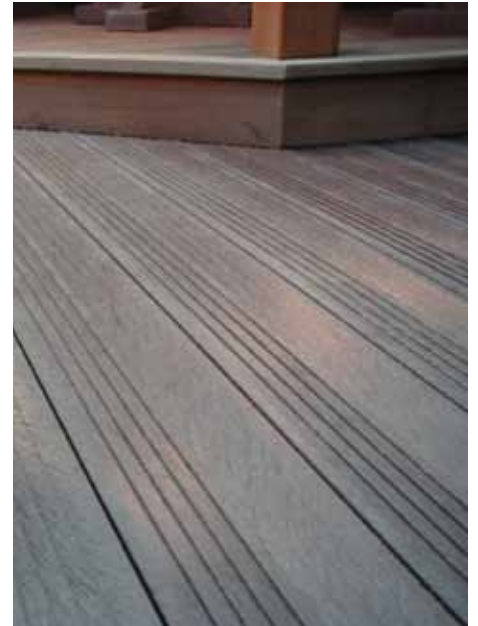

Where two boards abut each other lengthways, it is recommended that these adjoining ends are fixed to the Plaswood posts by headless stainless steel nails to allow expansion at the opposite end where sufficient gap has been left to accommodate this.

#### RECOMMENDATION



It is advisable to saw all the boards to the required length at the same time in the same environmental conditions to prevent shrinkage/expansion due to temperature fluctuations.

#### RECOMMENDATION



For applications where more than one board is used in the overall length, it is advised to lay the boards in a half-offset staggered formation.



# General Decking

## DECKING BOARD INSTALLATION

4

### Expansion Intervals



The lower the temperature during installation, the greater the boards may expand. The decking boards have a maximum linear expansion of 0.109mm per m per °C.

It is vital to calculate the maximum expansion of the boards in order to calculate the correct distance between boards/wall/borders.

#### EXAMPLE

- Installation of 3.6m board at a temperature of 15°C.
- Max. temperature expected 40°C
- Temperature at installation 15°C
- Temperature difference 25°C
- Interval=0.109mm per m per 10°C  
 $=0.109\text{mm} \times 3.6 \times 25$   
 $=9.81\text{mm}$

### Finishing

Upon installation the application can be finished with a border.

There are a choice of colours available to compliment the application and the range of profiles allow for a variety of border types.



#### • Example 1

Border with square 80x80mm board. Saw the boards to size using a mitre and screw to the Plaswood posts.

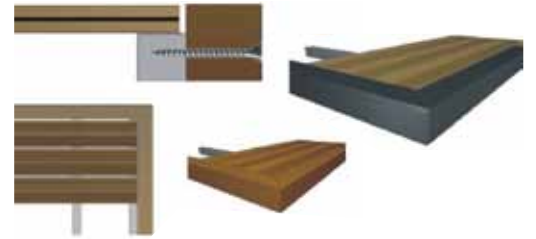

#### • Example 2

Border with corbelling (50 x 120mm board with board 32 x 150mm). Saw the 50 x 120mm board to size in a mitre and screw to the Plaswood posts before attaching the decking boards. Finish the border, after you placed the decking boards with a 32 x 150mm board screwed to the 50 x 120mm board.

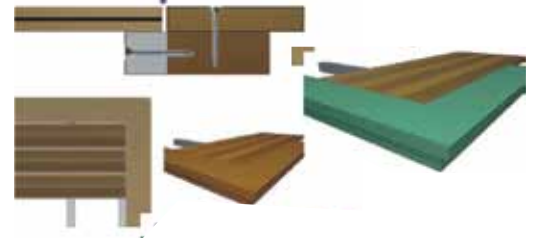

#### • Example 3

Vertical board. Choose a board from the range (40 x 120mm or 60 x 120mm) and screw it vertically to the Plaswood posts. As these boards are 120mm high, the board will need to be placed a few mm in the soil to make it level with the decking boards.

